

APPENDIX A

Site Analysis Plan

Conceptual Park Plan

Conceptual Graphics

Opinion of Probable Construction Cost

SITE ANALYSIS

MEMORIAL PARK CONCEPTUAL PLAN

EXISTING CONDITIONS

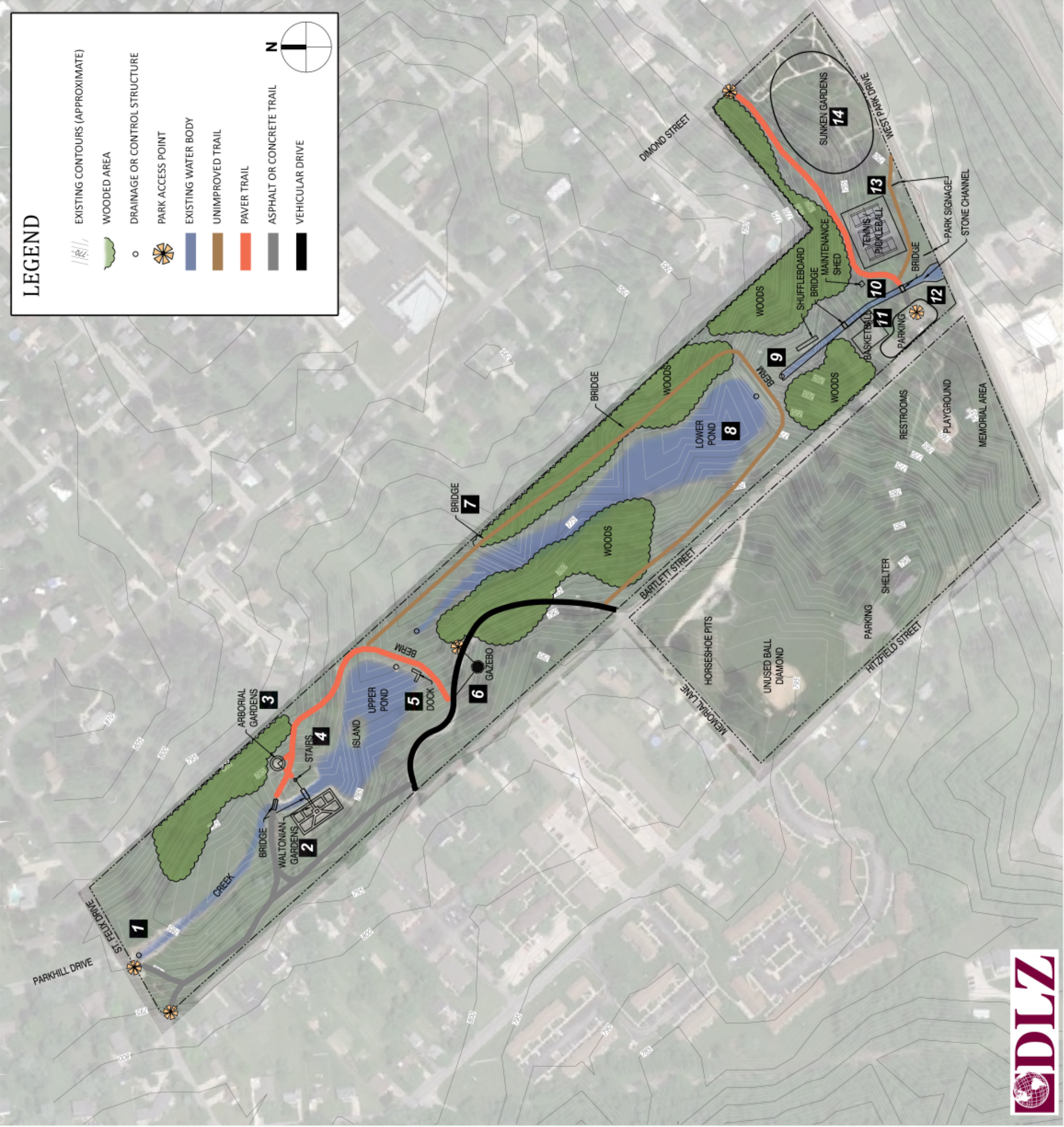

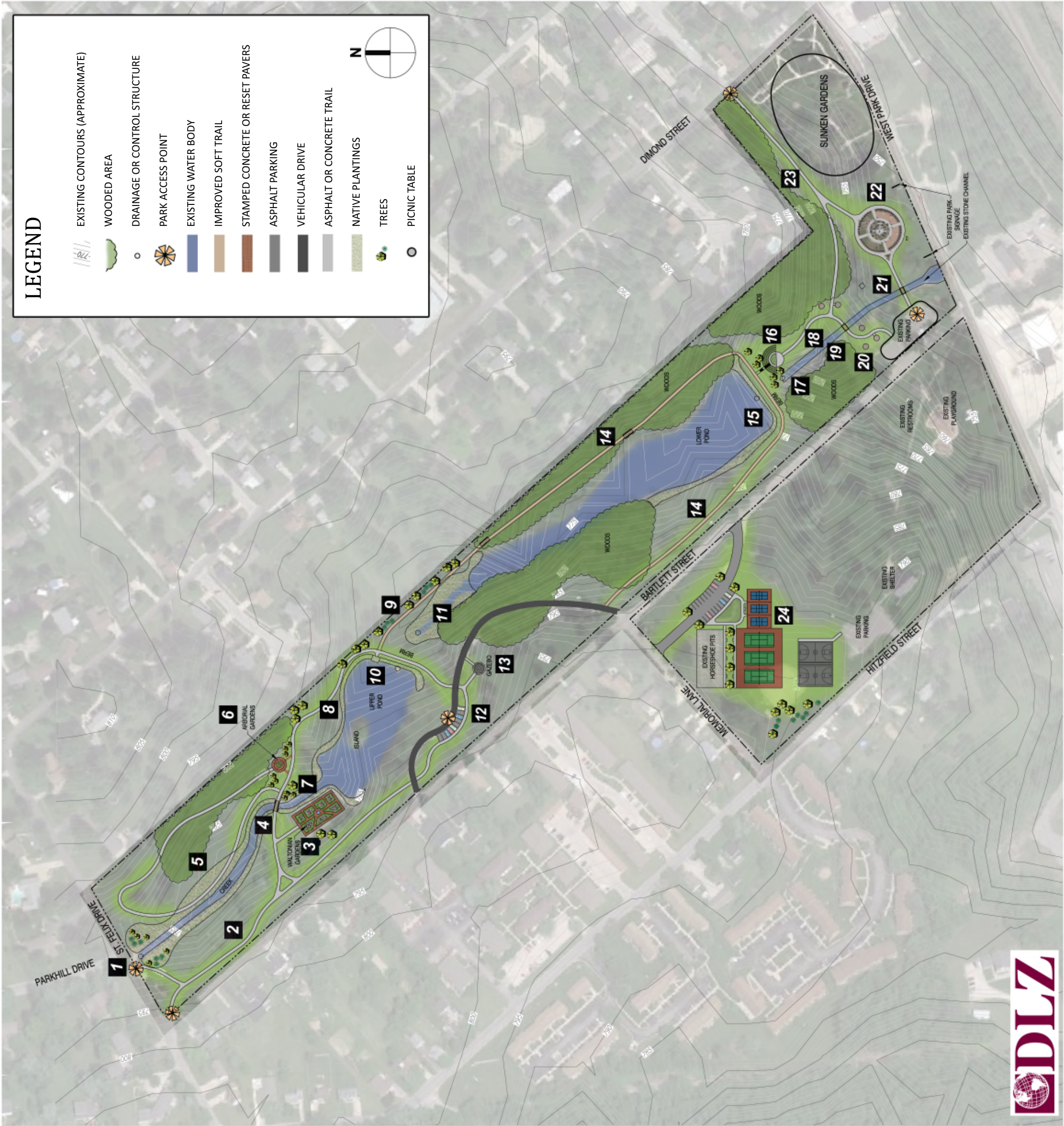

LEGEND

EXISTING CONTOURS (APPROXIMATE)

WOODED AREA

DRAINAGE OR CONTROL STRUCTURE

PARK ACCESS POINT

EXISTING WATER BODY

IMPROVED SOFT TRAIL

STAMPED CONCRETE OR RESET PAVERS

ASPHALT PARKING

VEHICULAR DRIVE

ASPHALT OR CONCRETE TRAIL

NATIVE PLANTINGS

TREES

PICNIC TABLE

N

IMPROVEMENT KEY

- 1

REMOVE AND REPLACE BANK ARMOR. PROVIDE NATIVE PLANTINGS ALONG BANKS.
- 2

REPAVE ASPHALT TRAIL (8' WIDTH) FROM ST. FELIX TO EXISTING DRIVE. PROVIDE CONNECTION TO NEW PARKING AREA.
- 3

REJUVENATE PLANTINGS AT GARDEN. REPLACE BRICK PAVERS WITH STAMPED CONCRETE. RESTORE FOUNTAIN. PROVIDE ACCESSIBLE CONNECTION FROM ADJACENT TRAIL.
- 4

WIDEN BRIDGE ALONG MAIN TRAIL. REPLACE DECK AND GUARDRAILS. REPLACE BRICK WALK WITH ASPHALT.
- 5

PROVIDE NEW ASPHALT TRAIL LOOP ALONG CREEK AND THROUGH WOODS TO ARBORIAL GARDENS.
- 6

REPAIR STONE EDGE, CONVERT FOUNTAIN TO PLANTING AREA. REPLACE BRICK PAVERS WITH STAMPED CONCRETE. PROVIDE NEW BENCHES.
- 7

REMOVE STAIR UNIT AND BRIDGE. RESTORE WITH PLANTINGS.
- 8

REMOVE BRICK TRAIL. REPLACE WITH ASPHALT AS ACCESSIBLE TRAIL. PROVIDE ACCESSIBLE SITE FURNISHINGS ALONG TRAIL.
- 9

DELINEATE PROPERTY EDGE WITH LOW UNDERSTORY PLANTINGS AND SELECTIVELY PLACED CANOPY TREES.
- 10

REPLACE DOCK WITH ACCESSIBLE OVERLOOK/FISHING PIER. DRAINAGE MODIFICATIONS PER REPORT NARRATIVE.
- 11

PROVIDE NATIVE WETLAND PLANTINGS AROUND EXISTING DRAINAGE STRUCTURES AND CREEK.
- 12

PROVIDE SMALL PARKING AREA PERPENDICULAR TO EXISTING DRIVE TO SERVE NORTH END OF PARK.
- 13

REPLACE WALK TO GAZEBO. PROVIDE ACCESSIBLE PICNIC TABLES.
- 14

IMPROVE EXISTING SOFT TRAIL LOOP (8' WIDTH) ADJUST TRAIL CONNECTIONS TO EXISTING WOOD BRIDGES TO MEET FLUSH WITH DECKING.
- 15

DRAINAGE MODIFICATIONS PER REPORT NARRATIVE.
- 16

TERRACE SLOPE WITH LOW RETAINING WALLS TO PROVIDE AMPHITHEATER. CONNECT TO SOUTH LOT WITH ACCESSIBLE ROUTE.
- 17

REPLACE BANK ARMOR. PROVIDE ENERGY DISSIPATION AT OUTLET. RESTORE ERODED AREAS.
- 18

REMOVE SHUFFLEBOARD COURT.
- 19

RESTORE WPA WALLS AND REPAIR UNDERCUTTING.
- 20

REMOVE BASKETBALL COURTS AND LIGHTING. REPLACE WITH PICNIC AREA.
- 21

REPLACE RAILING ON BRIDGES AND ADJUST TRAIL CONNECTIONS TO MEET FLUSH WITH DECKING.
- 22

REMOVE TENNIS COURTS AND ASSOCIATED UTILITIES. DEVELOP NEW VETERANS MEMORIAL SPACE
- 23

REMOVE BRICK TRAIL. REPLACE WITH ASPHALT FROM EXISTING BRIDGE TO DIMOND STREET CONNECTION.
- 24

NEW COURT SPORTS COMPLEX AND PARKING (TENNIS, PICKLEBALL AND BASKETBALL)

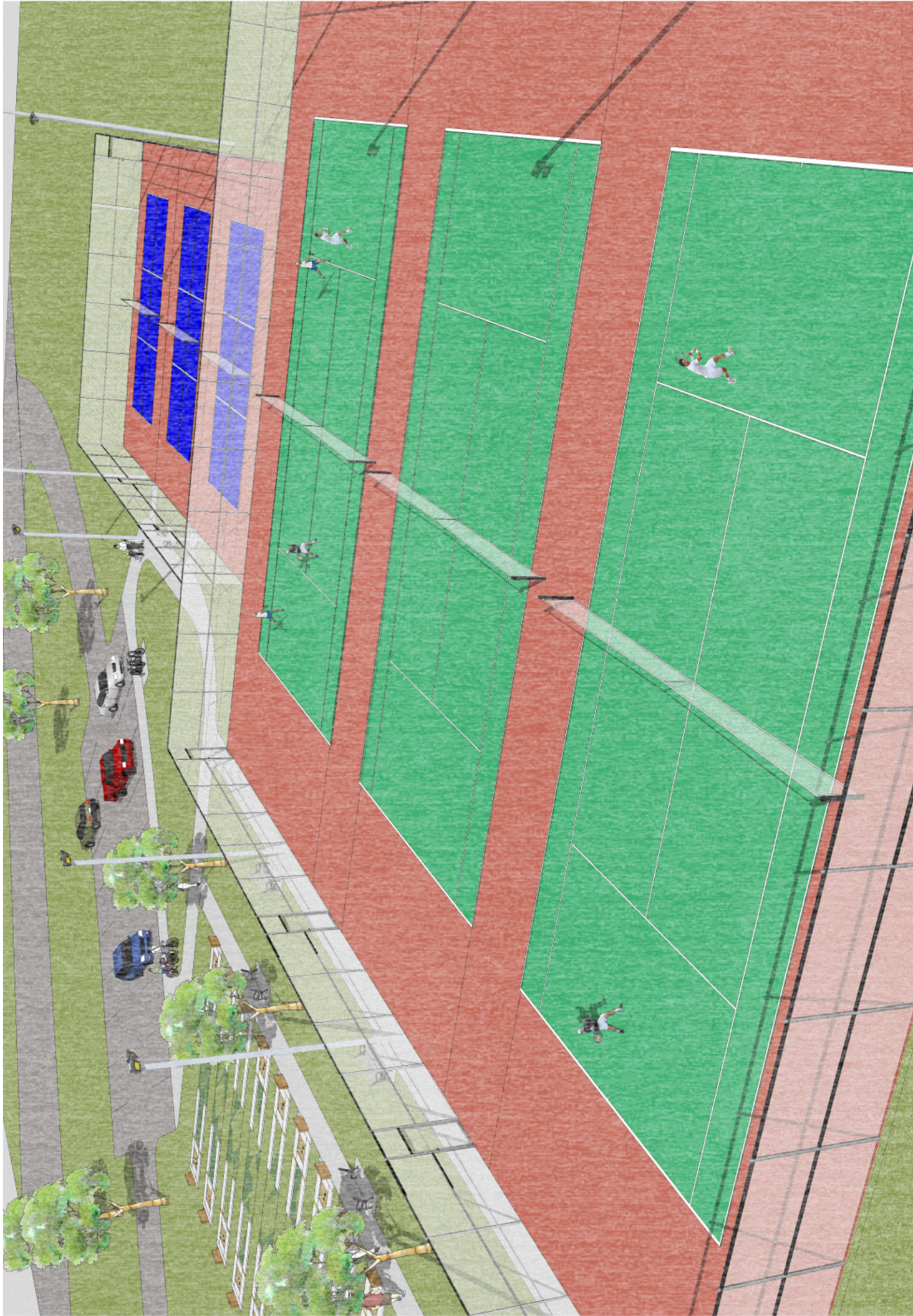

Memorial Park - Proposed Court Sports Complex

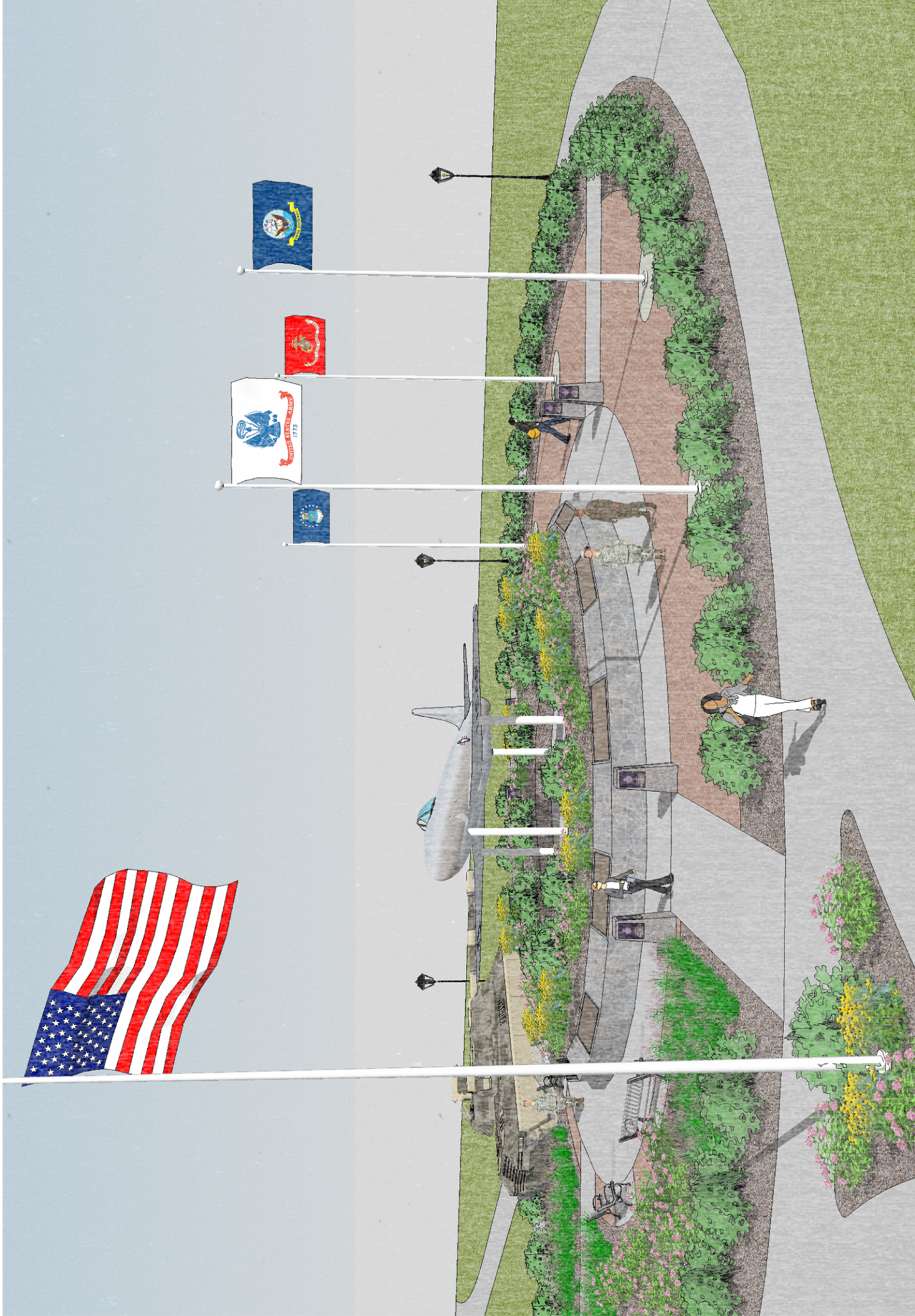



Memorial Park - Proposed Amphitheater



Memorial Park Conceptual Plan

Preliminary Estimate of Probable Construction Cost - 2014

Project No. 1266-2086

4/15/2014

Phase I - South End/Sports Improvements

Description	Total
Demolition	
Removal and Restoration at Existing Ball Diamond	\$5,000
Removal of Shuffleboard	\$850
Removal of Basketball Courts, Lighting, and Fence	\$3,825
Removal of Tennis Courts, Lighting, and Fence	\$13,050
Sports Improvements	
Court Complex Parking	\$49,350
New Basketball Courts (2)	\$84,000
New Tennis Courts (3)	\$167,000
New Pickleball Courts (3)	\$115,950
New Walk Access to All Courts	\$18,675
Site Furnishings	\$13,800
Lighting - Court complex	\$300,000
Miscellaneous Improvements	
Amphitheater	\$97,070
Amphitheater Structure	\$25,000
Picnic Areas	\$17,150
Renovate Bridges at Tennis Court / Channel area	\$9,850
New Veterans Memorial	\$199,245
Relocation of Plane and Tank by Owner (inclusive of structure)	Not Included
Drainage (Memorial and Sports Complex)	\$47,500
Lighting - Amphitheater, Memorial, Picnic Area	\$37,000
General Site Seeding and Tree Plantings	\$5,125
General Conditions (5%)	
	\$60,472
Contractor Markup (Overhead and Profit - 15%)	
	\$181,416
Construction Contingency (10%)	
	\$120,944
Estimated Phase I Construction Total	\$1,572,271

Description	Total
Phase II - Drainage/Pond Improvements	
Description	Total
Pond Improvements	
Dredging of Upper Pond (Estimated 2' depth)	\$22,000
Dredging of Lower Pond (Estimated 2' depth)	\$52,500
Seeding at Pond Edges and Lowlying Areas	\$17,700
Channel Improvements	
Meandering Wetland at Channel North of Upper Pond	\$19,800
Stabilization at Base of WPA Walls	\$15,000
Reconstruction of WPA Walls at Lower Pond Structure (including fill)	\$18,250
Miscellaneous Improvements	
Fishing Pier at Upper Pond	\$18,000
General Conditions (5%)	
	\$8,163
Contractor Markup (Overhead and Profit - 15%)	
	\$24,488
Construction Contingency (10%)	
	\$16,325
Estimated Phase II Construction Total	\$212,225
Phase III - North End/Trail Improvements	
Description	Total
Demolition	
Removal of Existing Asphalt and Brick Trails	\$3,540
Stair Removal	\$500
Remove South Bridge	\$1,500
Waltonian Gardens	
Garden Plantings	\$18,070
Irrigation	\$12,000
Fountain Restoration	\$15,000
Colored, Stamped Concrete Walks	\$37,560
Renovate North Bridge, Widen to 8' Width	\$16,250

Description	Total
Arboreal Gardens	
Arboreal Garden Plantings	\$4,575
Stonework Restoration	\$2,500
Colored, Stamped Concrete Walks	\$12,225
Trail Construction	
Replacement of Existing Trails (Asphalt)	\$82,295
New Water's Edge Loop (Asphalt)	\$27,730
Improved Soft Trail	\$25,620
Miscellaneous Improvements	
Lover's Lane/Gazebo Parking	\$13,760
Site Furnishings & Signage	\$11,800
General Site - Tree Restoration and Screening Plantings	\$18,700
Lighting	\$168,500
General Conditions (5%)	\$15,181
Contractor Markup (Overhead and Profit - 15%)	\$45,544
Construction Contingency (10%)	\$30,363
Estimated Phase III Construction Total	\$563,213
Estimated Total Project Construction	\$2,347,710

APPENDIX B

Meeting Minutes (Kick-off and Programming)

Meeting Minutes (Preliminary Review)

**Excerpt from Huntington Parks and Recreation
Department 2011 – 2015 Master Plan**

**Excerpt from City of Huntington
ADA Self Evaluation and Transition Plan**

MEETING MINUTES

MEETING DATE: November 25, 2013

WRITTEN BY: Sara Rhodes

MEETING LOCATION: Huntington City Hall, Mayor's Office

PURPOSE OF MEETING: Memorial Park Kickoff and Programming Meeting – Proj. No. 1266-2086

ATTENDEES: Mayor Brooks Feters (City of Huntington)
Anthony Goodnight (City of Huntington)
Bob Caley (City of Huntington)
David Henkle, John Nelson, Sara Rhodes, Todd Thurber (DLZ)

A. Vision and Programming

1. Discussed City's vision for the Park
2. Identified current uses, desired improvements and priorities.
 - a. Sports: Current sport uses include Tennis, Pickle Ball, Disc Golf and Basketball. Separate facilities are desired for Pickleball as it is damaging tennis court equipment. All sports elements may be relocated as needed. Additionally, if space is needed for relocations, ball field is no longer in use as the Hier's Park facility is being utilized. Would like to renovate basketball court.
 - b. Gardens: Would like to limit maintenance. In other areas, the city would like to start tree plantings for eventual replacement of mature and storm damaged trees. Would be interested in using strategic plantings to delineate boundaries of property, but maintain openness and visibility.
 - c. Memorial: City wants to take some time to focus on the "Memorial" part. They are working on getting updated plane and tank. Relocation was originally slated for the area near tennis courts in the 2010 5-year parks master plan.
 - d. Ponds/Drainage: Southern pond has existing leak and is being filled from the west. Stagnancy of ponds is a high priority concern. Ponds were former fish hatchery area. Erosion along channels and outlets is a concern. Clean up banks of ponds and creek. May include new options for bank armor and native plantings. Bridges require replacement for accessibility and safety.
 - e. Trails: Would prefer one quality trail over quantity. Local cross country teams use wooded

trails for training/meets and would like them to remain. Want connection to Sunken Gardens.

- f. Parking: The City is interested in improving parking near the gazebo. Current informal parking is located along Memorial Lane.
 - g. Accessibility (ADA): Items identified in the 2012 Self-Evaluation and Transition Plan should be included in future park development.
 - h. Other items of interest: Amphitheater, raised beds and canopy structures similar to Kreager Park in Fort Wayne, restoration of fountains, interpretive signage, use of forest green and black trim on any proposed structures
3. Discussed level of maintenance (current and future) and known issues.
- a. Mayor has recently developed Community Engagement position. They will be looking for help from community volunteer groups in maintenance of parks.
 - b. Limit maintenance by providing less space for planting areas, but maintaining a higher quality where included.
4. Local historical information available (Indiana Room, Historic Review Board).
- a. DLZ is reviewing the historical information available at the Library to determine specific areas of historical significance.
 - b. Confirmed that portions of the rockwork within the park are WPA projects in 1937. This should be considered when impacting these areas.
5. Limits confirmed per contract scope. Parks property on west side of drive may be used conceptually for relocation of sports areas as needed, but will not be studied.

B. Funding / Historical Impacts

- 1. Discussed impact of different types of funding on historical documentation / approval requirements. Federal funding would invoke provisions of 106 of the National Historic Preservation Act. Transportation Enhancement funding would invoke Section 4F. Local funding would only require local Historic Review Board approval. It is assumed that any improvements proposed would be respectful of historically significant items, and have a minor effect in the best interest of the property.
 - 2. City will confirm that Land and Water Conservation Funds have not been used in the Park in the past.
 - 3. Grant application for addition of Park to National Registry of Historical Places is still underway.
-

C. Next Steps

1. Conducted field inventory and site analysis on 11/25/2013.
2. Develop preliminary Conceptual Park Plan (December).
3. Present Plan to City, including opinion of probable construction cost and phasing. (Schedule meeting week of 1/6/2014)
4. Finalize Conceptual Park Plan and develop various renderings for marketing purposes. (1/31/2014)

The foregoing constitutes our understanding of matters discussed and conclusions reached. Please review these items and advise the undersigned, in writing and within five (5) business days, of any errors or omissions.

DLZ INDIANA, LLC



Sara Rhodes, PLA, LEED AP, CPESC-IT

srhodes@dlz.com

Cc: Those in attendance, cgh, file

MEETING MINUTES

MEETING DATE: February 27, 2014

WRITTEN BY: Sara Rhodes

MEETING LOCATION: Huntington City Hall, Mayor's Office

PURPOSE OF MEETING: Memorial Park Preliminary Plan Review Meeting – Proj. No. 1266-2086

ATTENDEES: Mayor Brooks Feters (City of Huntington)
Anthony Goodnight (City of Huntington)
Bob Caley (City of Huntington)
John Nelson, Sara Rhodes (DLZ)

A. Presented Site Analysis

B. Presented Preliminary Conceptual Park Plan

1. New or Relocated Improvements

- a. Tennis/Pickleball Complex – City liked location and confirmed number of courts shown are acceptable.
- b. Basketball - Location may better serve adjacent higher density residential and good proximity to newly renovated shelter.
- c. Amphitheater – City feels this would be a large attraction and is not a feature currently in the park system.
- d. Veterans Memorial – Plans are underway to get the existing plane rehabilitated. Discussion was held regarding if this should be done and reset in current place, or if this should be placed in the proposed location. If replaced where currently located, it would need to be placed on raised platform to prevent kids from playing on it. Consensus was reached that a single move of the plan was likely to be viewed more positively and be more cost effective. This area is envisioned for use for ceremonies, etc and to honor all branches of the military. The City likes the visibility of the proposed location.
- e. Picnic Area is a good addition.
- f. The City would like the park to have lighting for safety purposes. Lighting/electrical will be added to the plan and estimate to reflect appropriate levels of lighting for a park using decorative fixtures.

- g. Disc golf course should not be impacted by any of the proposed improvements.

2. Renovation

- a. Paths – City agreed that these are major use areas, but would like to see this occur as part of the second phase of improvements. Also noted that the plan should address bike route through (or adjacent to) the park. It was discussed that bike traffic could enter the park trail at St. Felix, use multi-use trail and park roadway to reach Memorial Lane, and then follow future dedicated bike lane along Bartlett to reach either West Park drive or the connecting trail from the south parking lot to Dimond Street. Larger vision includes bike route from Schenkel’s Dairy (near intersection of Flaxmill and US 24) to Sunken Gardens.
- b. Fountains and Gardens – Discussed current state of each fountain area. The City would like to see the fountain at Waltonian Gardens rehabilitated as they envision this area for use in gatherings, weddings, etc as in past. The Arboreal garden presents more challenges to restore. The City agreed in light of this and the maintenance required for another fountain that they would like to see this converted to a focal point planting area maintaining the stone work at the perimeter.
- c. Bridges – Discussed the various options for rehabilitation, removal, and expansion of the bridges. The City would like to see the northernmost bridge widened and the other removed at the Waltonian Gardens. On the south end near the tennis courts, both bridges should be shown as widened. The remaining bridges will be assumed to have a more decorative railing system.

C. Phasing

- 1. Phase I will include all improvements south of the Lower Pond berm, including the new memorial space, relocation of the plane, amphitheater, picnic area, and bridges, as well as the new tennis/paddleball complex and parking, and the basketball courts.
- 2. Phase II will include all improvements to the Upper and Lower ponds and creek.
- 3. Phase III (or concurrent with Phase II) will include all other work north of the Lower Pond berm, including the Waltonian Garden, trails, new parking area at the Gazebo, and bridges.

D. Next Steps

- 1. DLZ civil engineer to make site visit to finish review of drainage structures, erosion and pond issues when weather allows.
 - 2. Finalize Conceptual Park Plan document.
 - 3. Prepare final opinion of probable construction cost and outline potential phasing plan.
-

4. Develop perspective or section renderings for marketing purposes. Areas to be addressed will include the Waltonian Garden, the tennis/paddleball complex, the amphitheater and the Memorial.

The foregoing constitutes our understanding of matters discussed and conclusions reached. Please review these items and advise the undersigned, in writing and within five (5) business days, of any errors or omissions.

DLZ INDIANA, LLC

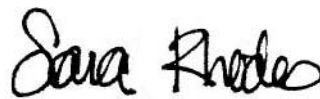

Sara Rhodes, PLA, LEED AP, CPESC-IT

srhodes@dlz.com

Cc: Those in attendance, cgh, file



Huntington Parks
and Recreation
Department

**2011-2015
MASTER PLAN**

Priority Memorial Park

A	Construct sidewalk along W. Park Drive from Sunken Gardens to Hitzfield Street
A	Construct sidewalk to Memorial Small Pavilion from main sidewalk
A	South Pond - dredge and reseal with clay, seal leak in earth dam
A	Develop Veterans Memorial Garden. Relocate tank and jet plane. Develop honor wall for Huntington County veterans, flag plaza with US flag and flags from all branches of service, incorporate other military vehicles and equipment. Possible location is the tennis courts along W. Park Drive.
A	Replace restroom facility
A	Install benches around playground for adults
A	North Pond - replace brick walkway
A	Establish tree planting/reforestation plan for Memorial Park
A	Renovate horseshoe courts - reduce from 12 to 6 courts, upgrade courts, lighting, benches, etc. Construct small open shelter.
A	Remove ball diamond (no longer in use), develop green space
A	Waltonian Gardens - replace brick walk with colored stamped concrete walk
A	Construct 6 new tennis courts on site of former ball diamond.
B	Waltonian Gardens - replace old wood benches and trash receptacles
B	Pave aggregate walking trail
B	Hire arborist, prune trees throughout park
B	Shakespeare Gardens - landscape enhancements
B	Improve gravel parking area by horseshoe courts.
B	Repair/reconstruct headwall at culvert on St. Felix Drive ditch
B	Expand disc golf course to 18 holes
B	North End Gazebo - replace brick walk with colored stamped concrete walk
B	North Pond - develop sitting areas overlooking pond
B	Memorial Large Pavilion - total renovation: roof, fascia, stonework, electrical, etc.
B	Replace chain link fence along creek at basketball court
B	Construct concrete grill pad & countertops at Memorial Small Pavilion
B	Waltonian Gardens - restore brick fish pond
B	Upgrade tennis courts lighting





Huntington Parks
and Recreation
Department

2011-2015 MASTER PLAN

Memorial Park

2011	Construct sidewalk to small pavilion from main walkway	\$4,000	Park Budget #433 / NR Capital
2012	Replace restroom facility	\$42,000	Park Budget #421 / NR Capital
2012	Construct sidewalk along W. Park Drive from Sunken Gardens to Hitzfield Street	\$23,520	Park Budget / City Funds
2012	Remove ball diamond & fencing (no longer in use), develop green space	\$500	Park Budget
2013	Develop tennis complex and shelter	\$450,000	Park Budget / City Funds / TIF
2014	South Pond - dredge and reseal with clay, seal leak in earth dam	\$20,000	Park Budget
2014	Develop Veterans Memorial Garden. Relocate tank and jet plane. Develop memorial for Huntington County veterans, flag plaza with US flag and flags from all branches of service, incorporate other military vehicles and equipment. Possible location is the tennis courts along W. Park Drive.	TBD	Donations
2014	Renovate horseshoe courts - reduce from 12 to 6 courts, upgrade courts, lighting, benches, parking lot, etc. Improvements on Memorial Lane and Bartlett Street	\$180,000	Park Budget / City Funds / Donations
2015	Waltonian Gardens - replace brick walks with colored stamped concrete	\$20,000	Park Budget / NR Operating
2015	North Pond - replace brick walkway, extend walkways through park	\$150,000	Park Budget / Grants

Total \$890,020

Trails and Greenways

2012	Construct trail from Memorial Park to Forks of the Wabash along W. Park Drive	\$350,000	INDOT Grant / Park Budget
2012	Establish road signage/stripping for on-road bike lanes	\$2,500	Park Budget / Grants
2013	Establish road signage/stripping for on-road bike lanes	\$2,500	Park Budget / Grants
2014	Establish road signage/stripping for on-road bike lanes	\$2,500	Park Budget / Grants

Total \$357,500

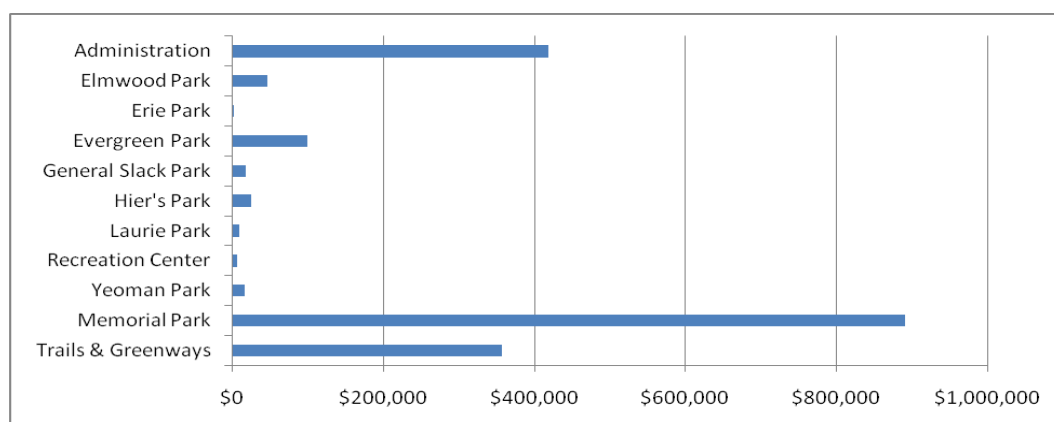

- Transfer platform is too high and height of risers on transfer steps is not equal and steps are not level.
- Restrooms have non-compliant signage, sinks that are too high, pipes under the sinks are not insulated, space on the narrow side of the toilet is excessive, rear grab bars are not properly installed, and coat hooks are too high.
- Memorial Park/Sunken Gardens/Shakespeare Gardens – Memorial Park is one of the largest parks in the City and houses a number of programs. Included at Memorial Park are Waltonian Gardens, Shakespeare Gardens, and Sunken Gardens. Sunken Gardens is registered on the National Register of Historic Places. The park a number of barriers and/or non-compliant items, including:
 - The parking lot at the main entrance off Park Driver has very faint pavement markings, an access aisle that is too narrow, and no signage at the barrier-free parking. The curb ramp has a lip at the gutter line that exceeds ½”.
 - The parking lot near the stone pavilion on the west side of the park has no barrier-free parking or signage provided.
 - The walks in the park have sections that exceed 5% running slope, sediment deposited on the walk, surfaces that are in poor condition, has gaps at transitions in material, have surface level changes and cracking with gaps, surfaces that are not compliant (slippery when wet), areas with excessive cross slope, areas that are too narrow, segments over 200’ in length with no passing spaces, sections that include stairs, and sections with materials that have excessive gaps (bricks).
 - The stairs accessing Waltonian Gardens have risers that are not uniform height, are not slip resistant material (stone), and have handrails that are not compliant.
 - Drinking fountains provided in the park are single units (not hi-lo), don’t have adequate underclearance and have bubblers that are too high for wheelchair users, are not located on level ground, and/or require excessive force to operate.
- Restroom doors have surface level change at the thresholds. The restrooms are not located on an accessible route, do not have compliant signage, do not have insulation on pipes under sinks, have mirrors, light switches, and electrical outlets that are too high, barrier-free stalls do not have handles on the outside of the door, grab bars are too short, toilet paper dispensers block the grab bar, and coat hooks that are too high.
- There are no accessible routes to grills, horseshoe area, tennis courts, basketball area, or baseball/softball field. There are no wheelchair spaces provide in bench areas at the baseball field.
- There are no accessible routes into the play area or to any ground level play components, the surfacing material is not compliant, no level clear area is provided adjacent to play components, and the turning space on the play structure is less than 60” diameter.
- The shelter near the play area has electrical outlets that are blocked by picnic tables and is too high. The stone shelter has a concrete floor with extensive cracking that has separations and level changes.
- Sunken Gardens has no compliant parking, the walk/ramp from the parking area has excessive slopes and is not a compliant surface, no handrails are present in the tunnel, all sets of steps and handrails have numerous compliance issues, the wooden sitting area on the intermediate level has no accessible route connecting it, and the area is wood (slippery when wet).
- Shakespeare Gardens has walks with areas of excessive running slope and cross slope, surface level changes, and landings that are not level, picnic table sin the shelter block the PAR through, access to the end of the picnic tables for wheelchair is not available in the current layout, picnic table blocks access to the

- electrical outlet, and the light switch in the shelter is too high.
- Riverside Park – has no facilities or programs so is compliant
 - Yeoman Park/Hayes-Lemmerz Skate Park/Erie Park – houses a number of programs and has a number of barriers and/or non-compliant items, including:
 - The site has three parking areas, all of which lack van-accessible and barrier-free parking and signage. North parking lot is gravel and provides no compliant surface for barrier-free parking spaces.
 - Areas of sidewalk have excessive slopes and surface level changes.
 - The drinking fountain near the skate park has several compliance issues.
 - A step is required to access the restrooms from the adjacent PAR, an excessive level change is present at the door, and the door has no handles on the pull side.
 - Bleachers at the ball field have no wheelchair spaces or companion seating and are not located on an accessible route.
 - Clear space around all sides of picnic tables is not available (tables are attached) and they block the clear space at the grill. Underclearance at picnic tables is too low for wheelchair user.
 - Clear space adjacent to benches is not provided and no accessible route is provided to the skate park viewing area, baseball/softball diamond, soccer fields, and basketball courts. No accessible route connects both sides of sports fields and no wheelchair spaces are provided in baseball player bench areas.
 - There are no accessible routes into the play area or to any ground level play components, the surfacing material is not compliant, no level clear area is provided adjacent to play components, and the transfer platform is too high.
 - Restrooms do not have compliant signs, have inadequate sink underclearance height and depth, pipes under the sinks are not insulated, mirrors and light switches are too high, urinal lips are too high, barrier-free stalls have no handles on the inside, stall widths are too narrow, toilet flush controls are on the narrow side of the toilet, toilet paper dispensers are not located properly, and grab bars are not properly installed.
 - Homier Park – houses primarily baseball/softball games and support programs and has a number of barriers and/or non-compliant items, including:
 - The parking lot is not a compliant surface. Markings are not obvious and access aisles are not properly marked to prevent parking. Signage does not include any van-accessible spaces and mounting height of signs is too low.
 - Walks are of various materials including compacted limestone that is generally compliant but requires maintenance, surface level changes exist at the interface with concrete, areas of the PAR near the restroom breezeway have concrete width less than 36", three concession window shelves, drinking fountain, and air conditioner protrude, and drinking fountain is not hi-lo.
 - Grandstands at all four fields lack wheelchair spaces and companion seating. No wheelchair spaces are provided in player seating areas.
 - Picnic tables have insufficient knee space depth.
 - Restrooms have excessively high threshold, signage is not compliant, accessible sinks do not have pipes insulated, mirrors, light switches, and electrical outlets are too high, barrier-free stall does not have handles on the inside of the door, toilet is too far from the near wall, flush controls are on the narrow side of the toilet, toilet paper dispenser is not located properly, grab bars are mounted too high, too short, and/or are not centered properly, and coat hooks are too high.
 - City Parking Lots – the City owns property for public parking outside the public ROW in seven different lots. All have various issues, barriers, and/or non-compliant items, including:
 - Lack of barrier-free parking
 - Lack of van-accessible parking

Memorial Park, 1200 W. Park Drive

Exterior			
Item #	Description	Priority	Estimated Cost
1-1	Parking at main entrance		
	<i>Access aisle for BF parking spaces is only 7'6" width. NOTE: Existing total dimensions are adequate for two, 8' spaces and one, 8' access aisle. Existing paint is very faint.</i>		
	Repaint BF spaces to correct dimensions. Federal Guideline: 208.2, 502	High	\$ 100
	<i>Cross-slope of access aisle is 2.5% (2.0% max allowed).</i>		
	Consider relocating BF parking to opposite side of parking lot (nearer play area), which appears to get much more use. Federal Guideline: 502.6	Medium	\$ 100
	<i>No signage is present.</i>		
	Provide compliant signage at parking space when provided (including van-accessible sign). Federal Guideline: 502.6	High	\$ 150
1-2	Parking on west side of park at stone pavilion		
	<i>No barrier-free spaces provided, one van-accessible required based on dimensions that provide 18+ parking spaces.</i>		
	Provide dedicated BF parking space in the area. Federal Guideline: 208.2, 502	High	\$ 100
	<i>No signage is present.</i>		
	Provide compliant signage at parking space when provided. Federal Guideline: 502.6	High	\$ 150
2-1	Ramp at BF parking access aisle main entrance lot		
	<i>Existing lip at curb gutter line exceeds 1/2".</i>		
	Consider grinding lip of curb to eliminate vertical change. Federal Guideline: 406.1, 406.3	Medium	\$ 380
4-1	Walks east of entrance parking lot		
	<i>Walk exceeds 5% running slope for entire section leading to bridge. East of the bridge the material is either bricks (which have excessive openings) or lawn/dirt. Access provided only to tennis court.</i>		
	Review options to provide wheelchair access to tennis courts. Will likely involve construction of a ramp, walk east of the bridge, and modifications to the bridge to provide edge protection. Additional investigation required, no cost provided. Federal Guideline: 403.3, 403.4	High	TBD
4-2	Walks west of entrance parking lot at play structures		
	<i>South portion of walk leading to ROW has a surface in poor condition (asphalt). Gaps in PAR exist at connection from concrete to asphalt at two locations.</i>		
	Reconstruct walks. Federal Guideline: 403.3, 403.4	Medium	\$ 4,000
	<i>Two areas have sediment deposition adjacent to retaining walls.</i>		
	Provide permanent erosion control, remove sediment. Federal Guideline: 403.2, 302.1	High	\$ 100

	<i>Small surface level change (>1/4" but not beveled) at far west landing.</i>		
	Consider grinding to eliminate vertical change. Federal Guideline: 403.2, 302.1	Medium	\$ 380
4-3	Walks on west side of park from west parking to restrooms and stone picnic pavilion		
	<i>Section of walk from the stone pavilion to the walk accessing the play area exceeds 200' in length but has no 60"x60" passing space. Most of the segment between the restrooms and play area exceeds 5% running slope. Many areas exceed 2% cross slope. Surface is poor condition asphalt with extensive irregularities.</i>		
	Reconstruct walks to provide passing spaces and compliant slopes. Federal Guideline: 403.3, 403.4	Medium	\$ 6,000
	<i>Concrete walk just east of stone pavilion has several cracks that have surface level changes exceeding 1/2" and openings that exceed 1/2" width. Cross slope exceeds 6.5% (2% max. allowed).</i>		
	Replace entire section of concrete. Federal Guideline: 403.2, 302.1, 403.4, 303, 302.3	Medium	\$ 5,000
	<i>Section of walk from parking to the stone picnic pavilion exceeds 5% running slope. Landing at change in direction at asphalt path has cross slope that exceeds 5% (2% max. allowed).</i>		
	Investigate options to provide access to stone pavilion using ramps. Will require detailed survey and design to determine options and feasibility to access north side (closest to parking and does not have steps) Federal Guideline: 403.2, 302.1	High	TBD
4-4	Walks on north side of park and around Waltonian Gardens		
	<i>Two segments of asphalt path exceed 200' in length and have no passing lane, asphalt is in poor condition with extensive irregularities.</i>		
	Reconstruct walks to provide passing spaces and compliant slopes. Federal Guideline: 403.3, 403.4	High	\$ 15,000
	<i>One set of steps is required to be used to access Waltonian Garden. Steps and handrails are non-compliant. Steps are stone and slippery when wet. Two bridges are in this section that are made of wood. Bridges have a number of compliance issues with gaps in the boards, no edge protection, slippery when wet, etc.</i>		
	Explore options to provide compliant PAR to Waltonian Garden. Option should include PAR that accesses from closest point from west, eliminating need to improve steps and bridges. Federal Guideline: 403.2, 302.1, 403.4, 303, 302.3	High	TBD
	<i>There are a number of surface level issues on all walk surface types. Asphalt surface is irregular. Pavers and bricks are heaved. Transitions to bridges are not flush.</i>		
	Correct all surface level changes to eliminate trip hazards. Cost provided is for ISA signage on accessible route TBD. Federal Guideline: 403.4, 303	High	\$ 500

	<i>Sections of the PAR include bricks with gaps that exceed 1/2", the gap in some boards on the bridges are excessive, some pavers are missing and create large voids, etc.</i>		
	Correct all separations/gaps in the PAR. Federal Guideline: 403.2, 302.3	High	Included above
6-1	Stairs accessing Waltonian Garden		
	<i>Riser height not uniform. Stair material is stone which is slippery when wet. Handrails are not compliant (galvanized steel pipe).</i>		
	Consider alternate access that does not require use of stairs. Alternatively repair the gaps in the stairs, install traction aides on the treads, and install compliant handrail system. Federal Guideline: 504.4, 405.8, 505	High	Included above
7-1	Drinking fountain on walk west of entry parking lot		
	<i>Only 1 type of fountain is provided, 2 required. NOTE: Evaluation done during winter, water not on so not able to fully assess compliance.</i>		
	Provide hi-lo drinking fountain or alternate accommodation. Federal Guideline: 211	Medium	\$ 3,500
	<i>Bottom of fountain is 26 3/4" above grade (27" min. required).</i>		
	Will be corrected with purchase of new hi-lo fountain. Federal Guideline: 306, 602.2	Medium	Included above
	<i>Clear space in front of drinking fountain is an irregular shape that is less than 30"x48".</i>		
	Will be corrected with installation of new PAR. Federal Guideline: 602.2, 305.2	See 4-2	Included above
7-2	Drinking fountain west side of park near stone pavilion		
	<i>Only 1 type of fountain is provided, 2 required. NOTE: Evaluation done during winter, water not on so not able to fully assess compliance.</i>		
	Provide hi-lo drinking fountain or alternate accommodation. Federal Guideline: 211	Medium	\$ 3,500
	<i>Bottom of fountain is 26 3/4" above grade (27" min. required).</i>		
	Will be corrected with purchase of new hi-lo fountain. Federal Guideline: 306, 602.2	Medium	Included above
	<i>Clear space in front of drinking fountain has a cross-slope of 6.5% (2% max. allowed).</i>		
	Will be corrected with installation of new PAR. Federal Guideline: 602.2, 305.2	See 4-3	Included above
	<i>Bubbler height is 37 1/2" above ground surface (36" max. allowed for wheelchair user). Bubbler located 5 1/2" from front of fountain (5" max. allowed).</i>		
	Will be corrected with purchase of new hi-lo fountain. Federal Guideline: 602.4, 602.5	Medium	Included above
7-3	Drinking fountain at softball field		
	<i>Only 1 type of fountain is provided, 2 required. NOTE: Evaluation done during winter, water not on so not able to fully assess compliance.</i>		
	Provide hi-lo drinking fountain or alternate accommodation. Federal Guideline: 211	Medium	\$ 3,500

	<i>No accessible route or clear, level space provided (is on grass area).</i>		
	Provide accessible route and 30"x48" space in front of fountain. Federal Guideline: 602.2, 305.2	Medium	\$ 1,500
	<i>Force required to operate controls is excessive (5 lbs. max. allowed). NOTE: Water was not on during evaluation.</i>		
	Verify that force exceeds allowance and determine what adjustments can be made once water is turned on in spring. Federal Guideline: 602.3	Medium	\$ 70
8b-1	Women's Restroom Door		
	<i>Change in elevation of over 1/2" (1/4" max allowed) exists at door.</i>		
	Remove lip by grinding or saw-cutting. Federal Guideline: 404.2.5	High	\$ 380
8b-2	Men's Restroom Door		
	<i>Change in elevation of over 1/2" (1/4" max allowed) exists at door.</i>		
	Remove lip by grinding or saw-cutting. Federal Guideline: 404.2.5	High	\$ 380
22-2	Site furniture at stone pavilion		
	<i>No accessible route is present to grill (is in lawn area south of pavilion). No clear, level 30"x48" clear space provided and centered on grill work space.</i>		
	Provide fully accessible route from pavilion to grill, including level work space. Federal Guideline: 206.2.2, 403, 1016.4, 804.3.1, 1011.2.1	Medium	\$ 900
24-1	Horseshoes		
	<i>No accessible route provided to sports area.</i>		
	Install compliant PAR to sports area. Federal Guideline: 206.2.2, 403, 206.2.12	Medium	\$ 2,400
24-2	Tennis courts and basketball		
	<i>No accessible route provided to sports area.</i>		
	Install compliant PAR to sports area. Federal Guideline: 206.2.2, 403, 206.2.12	See 4-1	TBD
24-3	Baseball/softball diamond		
	<i>No accessible route provided to sports area.</i>		
	Install compliant PAR to sports area. Federal Guideline: 206.2.2, 403, 206.2.12	Medium	\$ 4,500
	<i>No wheelchair spaces provided in player seating area.</i>		
	Install wheelchair space in each bench area. Federal Guideline: 221.2.1.4, 802.1	Medium	\$ 600
25-1	Play Area		
	<i>Accessible surface only around perimeter of play area. No accessible route provided into play area or to any ground level play component.</i>		
	Provide accessible routes into play area to each different play activity. Cost is for engineered wood fiber within entire area. Federal Guideline: 240.2.1.1.	High	\$ 1,700
	<i>Surfacing material is wood chips and not firm, stable surface.</i>		
	Install compliant surface for both accessibility and safety (engineering wood fiber or equivalent). Federal Guideline: 1008.2.6	High	Included above